

**Special Features**

- Case & measuring system in SS
- Static pressure up to 100 kg/ cm<sup>2</sup>
- Dry or liquid filled
- Accuracy upto 1.6% F. S.
- CE & Atex approved electrical contacts

**Application**

- |                  |                                     |
|------------------|-------------------------------------|
| ■ Chemicals      | ■ Power                             |
| ■ Refinery       | ■ Cement                            |
| ■ Nuclear        | ■ Sugar                             |
| ■ Aerospace      | ■ Food & Beverages                  |
| ■ Fertilizer     | ■ Pulp                              |
| ■ Petrochemicals | ■ Paper & allied Process Industries |
| ■ Pharmaceutical |                                     |

**Specifications**
**Standard Version : 100 mm & 150 mm**

Accuracy	: ±1.6% of F. S. (For ascending order)
Ambient temperature	: - 25°C to + 65°C
Process temperature	: Max 100°C
Static pressure	: 40 kg/cm <sup>2</sup> up to ranges 0.6 kg/cm <sup>2</sup> & 100 kg/cm <sup>2</sup> above ranges 1 kg/cm <sup>2</sup>
Over pressure limit	: 130% of Max. scale value

Case & Bezel	: AISI 304 SS (Bayonet Type)
Diaphragm	: AISI 316L SS (Double Diaphragm)
Nuts & Bolts	: AISI 304 SS
Process Connection	: Body : AISI 316 SS Thread Connection : 1/4" NPT(F) x 2 Nos.
Movement	: AISI 304 SS

Protection	: IP 65
Dial	: Aluminium, black graduation on white background
Pointer	: Aluminium, black coloured, Micrometer Zero Adjustable
Window	: Shatterproof / Safety Glass
Case Gasket	: Neoprene
Vent Plug	: EPDM
Element Chamber Filling	: Silicon Oil (Others on request)
Diaphragm Sealing Gasket	: Viton
Scale Amplitude	: 180° to 270° (For standard ranges)

**Glycerine filled version (option PY)**

Accuracy	: ±2.5 % of F. S. (For ascending order)
Ambient Temperature	: Maximum 65°C
Process Temperature	: Maximum 65°C
Window	: Plexi Glass
Dampening Liquids	: Glycerine 99.7% (others available as option)
Other Features	: Refer Specification of Standard Version

**Electrical contacts - dry version**

Accuracy	: ±2.5% of F. S. (For ascending order)
Ambient Temperature	: Maximum 65°C
Process Temperature	: Maximum 65°C
Window	: Polycarbonate Dome
Dampening Liquids	: Dielectric Oil (Optional)
Electrical Contacts*	: Refer How to Order
Other Features	: Refer Specification of Standard Version

\* Please specify contact set points while ordering.

**Temperature effect:**

The variation of indication caused by effects of temperature is to be calculated by below formula; which is to be added in the specified accuracy while measurement :- Formula :  $\pm 0.08 \times (t_2 - t_1) \%$  of F. S. where  $t_1$  = reference temperature (+20°C) and  $t_2$  = ambient temperature in °C.

Note : The addition of mechanical electric contacts affects the accuracy of instruments such that 1% becomes 1.5%, 1.6% becomes 2.4% etc. (Add the 50% of accuracy; If the contact is of the magnetically assisted type, this value can't be added within the ±5% of setting point.)

**Dimensions - standard version**

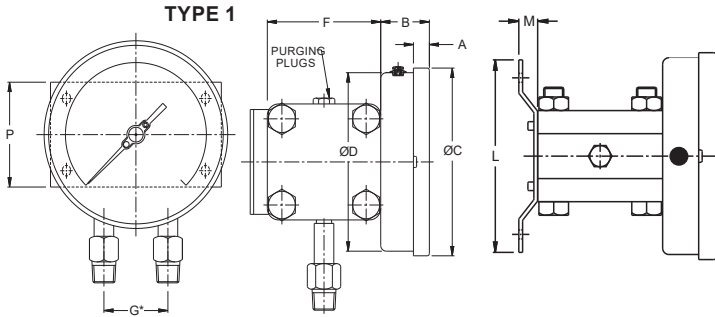

NS	A	B	ØC	ØD	F	G*	M	L	P	Weight in gram (With Box)
100	12.5	47	111	100	99	54	15	150	90	6450.0
150	15	49	161	149	99	54	15	150	90	6750.0

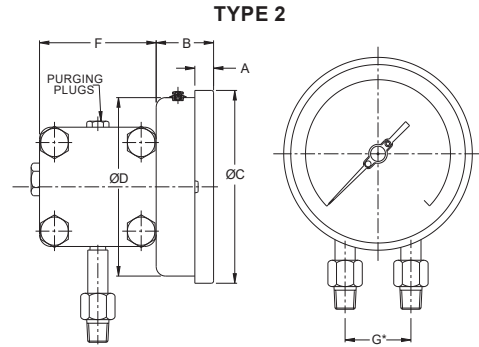

NS	A	B	ØC	ØD	F	G*	Weight in gram (With Box)
100	12.5	47	111	100	99	54	6150.0
150	15	49	161	149	99	54	6400.0

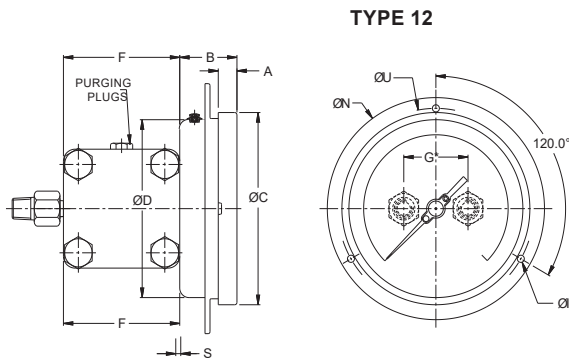

NS	A	B	ØC	ØD	S	ØI	ØN	ØU	F	G*	Weight in gram (With Box)
100	12.5	47	111	100	1	6	134	118	99	54	6250.0
150	15	49	161	149	1	6	186	168	99	54	6500.0

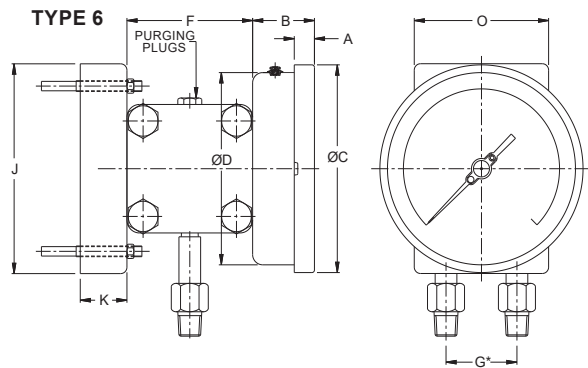

NS	A	B	ØC	ØD	F	G*	J	K	O	Weight in gram (With Box)
100	12.5	47	111	100	99	54	161	39	101	7250.0
150	15	49	161	149	99	54	161	39	101	7450.0

Notes : • Drawings are not to scale. • All Dimensions are in mm. • NS = Nominal Size. • \*Connections shown in drawings are optional.

**Range Table**

Note : We offer Pressure ranges in Scales like kPa, MPa, bar, psi, kg/cm<sup>2</sup> & Dual Scale like kPa with psi, kPa with bar, bar with psi or scales as per the requirement can be provided on request.

**Pressure range (Single Scale)**

High Pressure			
kg/cm <sup>2</sup>	kg/cm <sup>2</sup>	kg/cm <sup>2</sup>	kg/cm <sup>2</sup>
0/0.6	0/2	0/6	0/21
0/1	0/2.5	0/10	0/25
0/1.6	0/4	0/16	0/40

Note : Other Scale and ranges are available on request.

**Accessories (refer datasheet for complete specifications)**

\* Manifolds

\* Refer catalogue for Valves & Manifolds

**Range Table**

**Wiring diagrams for electric contacts**

**Single Contact**

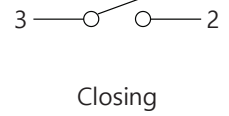
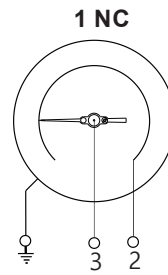
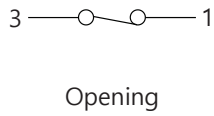
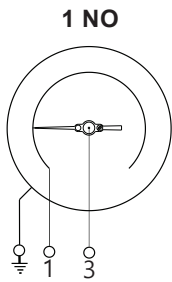

**Double contact**

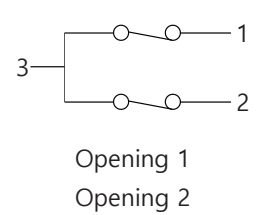
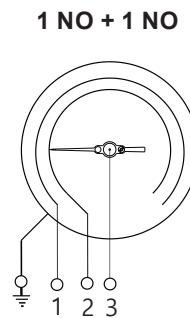
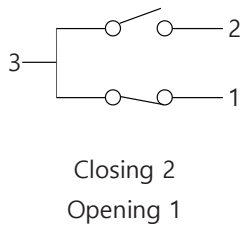
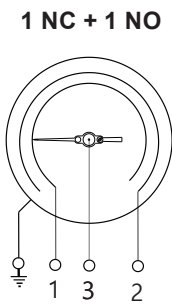
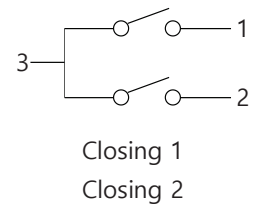
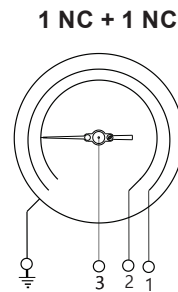
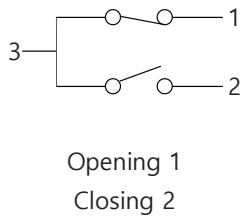
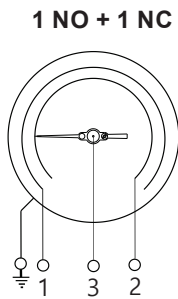

**Independent double contact**

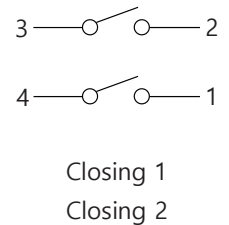
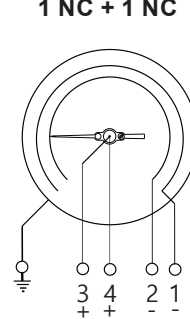
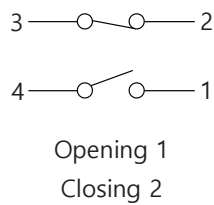
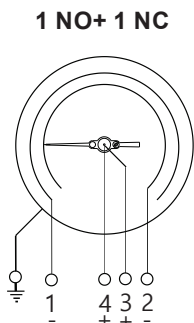

How To Order				Example	
<b>Basic Model</b>					
<b>Code</b>				AQ	
<b>Nominal Size</b>		100 mm	150 mm		
<b>Code</b>		<b>F</b>	<b>H</b>	X	
<b>Type of Mounting</b>					
1	Wall / surface / projection mounting with bottom entry				
2	Direct bottom entry			X	
6	2" pipe / yoke mounting bottom entry			OR	
12	Center back entry with front flange			XX	
<b>Process Connection (* These connections are provided through adaptors.)</b>					
<b>4BM</b>	1/4" NPT (M) x 1/2" BSP (M) X 2 Nos.*	<b>4BF</b>	1/4" NPT (M) x 1/2" BSP (F) X 2 Nos.*	XXX	
<b>4NM</b>	1/4" NPT (M) x 1/2" NPT (M) X 2 Nos.*	<b>4NF</b>	1/4" NPT (M) x 1/2" NPT (F) X 2 Nos.*		
		<b>2NF</b>	1/4" NPT (F) (Standard)		
Note: 1) For selection of Diaphragm Seals, refer individual data sheets. (The capillary length shall be maximum up to 3 meters & range shall be above 1 kg/cm <sup>2</sup> .) 2) Connections like Metric/ PT/ PF/ Flaired/ UNF/ G/ R etc can be provided on request.					
<b>Diaphragm</b>					
<b>UJ</b>	AISI 316L SS	<b>UM</b>	MONEL	XX	
<b>Central Chamber</b>					
<b>NF</b>	AISI 304 SS (Standard)	<b>RB</b>	AISI 316 SS	XX	
		<b>RD</b>	MONEL		
<b>Side Chamber (wetted parts)</b>					
<b>TP</b>	AISI 316 SS (Standard)	<b>TQ</b>	AISI 304 SS	XX	
		<b>TR</b>	MONEL		
<b>Filling Fluid</b>					
<b>UX</b>	SILICON DC 200 [-40 TO 205 °C / -40 TO 401 °F] (Standard)			XX	
<b>Range</b>					
Refer range table				0/2 kg/cm <sup>2</sup>	
<b>Options</b>					
<b>PS</b>	AISI 316 SS case & bezel	<b>TF</b>	Conformity as per NACE Standard	XX	
<b>PY</b>	Dampening liquid glycerine	<b>PU</b>	Calibration certificate traceable to National / International standards		
<b>QA</b>	Dampening liquid silicon oil	<b>PW</b>	Five point calibration certificate (For ascending scale only)		
<b>RH</b>	Custom designed dial	<b>GH</b>	Material test certificates#		
<b>SW</b>	Dial tag marking	<b>JU</b>	2" pipe/yoke mounting bracket & 'U' clamp (AISI 304 SS)		
<b>SX</b>	SS tag plate	<b>FN</b>	2" pipe/yoke mounting bracket & 'U' clamp (AISI 316 SS)		
<b>ZZ</b>	Dielectric oil filled				
# Material test certificates will be provided for wetted parts only with chemical composition testing. For others, Please consult factory.					
<b>Electric Contacts (CE &amp; Atex approved)</b>					
(For dry version, with ingress protection up to IP 55 & poly carbonate dome as a window)					
<b>A) Single insulated magnetic snap action type</b>		<b>B) Inductive type (220 V AC, 0.4 Amp.)</b>			
<b>(230 V AC, 1 Amp.)(48 V DC, 0.5 Amp.)</b>		<b>(Available for 1000 mm WC &amp; above )</b>			
<b>(Available for 1 kg/cm<sup>2</sup> &amp; above)</b>					
<b>RJ</b>	Single; normally closed (1 NC)	<b>YW</b>	Single; normally open (1 NO)	XX	
<b>RL</b>	Double; normally closed + normally open (1 NC +1 NO)	<b>YV</b>	Single; normally closed (1 NC)		
<b>RM</b>	Single; normally open (1 NO)	<b>YX</b>	Double; normally closed + normally open (1 NC +1 NO)		
<b>RL</b>	Double; normally open + normally closed (1 NO + 1 NC)	<b>YY</b>	Double; normally open (both NO)		
<b>RN</b>	Double; normally closed (both NC)	<b>YZ</b>	Double; normally closed (both NC)		
<b>RO</b>	Double; normally open (both NO)	<b>ZA</b>	Double; normally open + normally closed (1 NO + 1 NC)		
<b>RU</b>	Booster with relay for current upto 5 Amp.				
<b>RA</b>	SPDT				
<b>RC</b>	DPDT				

**Ordering Example: AQ . X . X OR XX . XXX . XX . XX . XX . XX . 0/2 kg/cm<sup>2</sup> . XX . XX**

For other optional items, please contact factory for delivery and minimum quantity of order.

Note : Specifications and dimensions given in this product catalogue represents the state of engineering at the time of printing .

Modifications may take place and materials specified may be replaced by others without prior notice.